

MDI 13/6 T2 0,18kW (300717800)

GENERAL DATA



MEDIUM PRESSURE FAN WITH FORWARD IMPELLER AND IN STAINLESS STEEL CONSTRUCTION

MANUFACTURING FEATURES:

- Welded stainless steel AISI 304 housing.
- Stainless steel simple inlet forward curved impeller.
- Standard asynchronous squirrel-cage motor with IP-55 protection and Class F insulation. Manufactured with standard voltages: 230V 50Hz for single phase motors, 230/400V 50Hz for three phase motors.
- Available positions (to be indicated in case of order): LG270, LG0, LG45, LG90, LG135, LG180, LG225, LG315, RD0, RD45, RD90, RD135, RD180, RD225, RD270, RD315.
- The indicated codes correspond to the model in position LG270.

APPLICATIONS:

Designed for inline installation, they are suitable for:

- Industrial applications, extraction or injection of air.
- Cooling of machines and parts.
- Clean air transport.
- Corrosive air transport.
- Maximum working temperature: carried air: 130°C, ambient: 1ph 50°C, 3ph 60°C.

UNDER REQUEST:

- 60Hz fans and special voltages.
- 2 speed motors (three phase motors).

PERFORMANCE CURVE

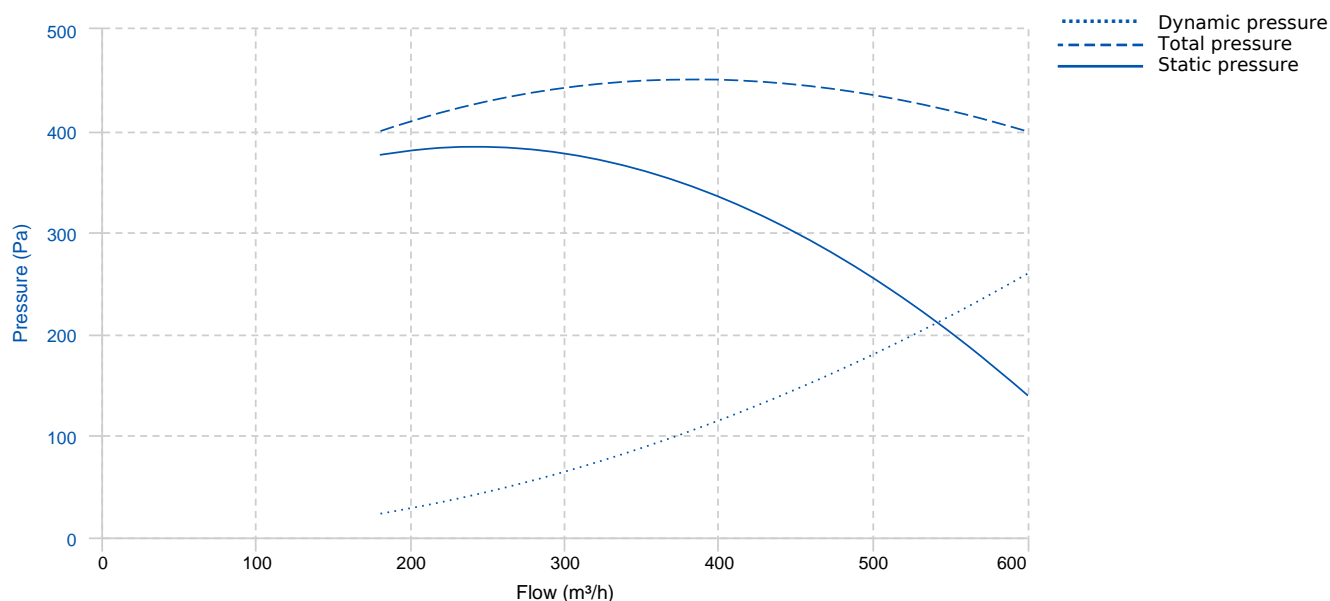

TECHNICAL DATA

| Fan | | | | | | | |
|-------|---------|----------------|--------|---------------|----------|---------------|--------|
| RPM | 2800 | Approx. weight | 5.3 kg | Max. Flow | 600 m³/h | | |
| Motor | | | | | | | |
| Power | 0,18 kW | RPM | 2800 | I max. (230V) | 0,87 A | I max. (400V) | 0,51 A |
| Size | 63 | Approx. weight | 3.8 kg | | | | |

DIMENSIONS

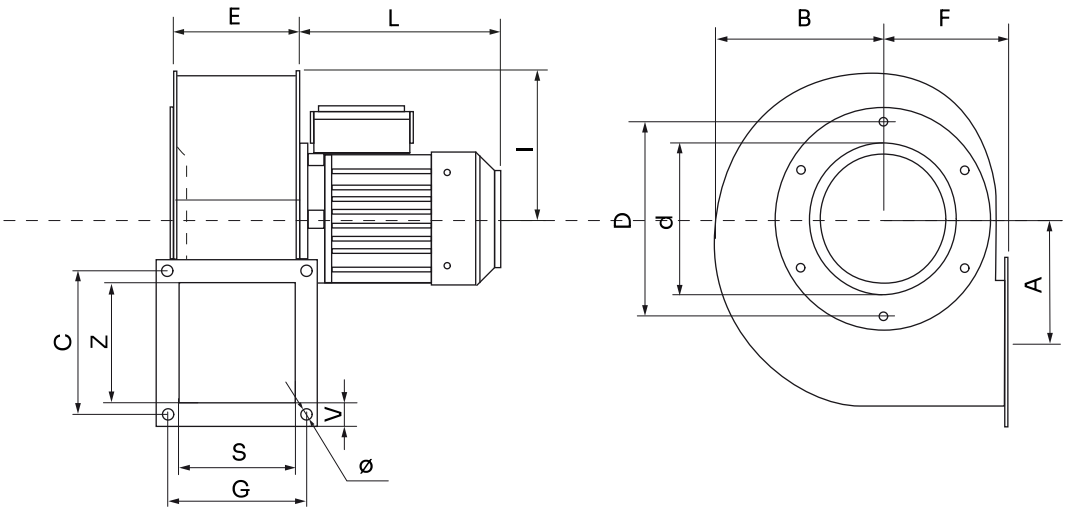

| Dimensions (mm) | | | | | | | | | |
|-----------------|-----|---|-----|---|-----|---|------|---|----|
| A | 92 | B | 125 | C | 110 | D | 158 | E | 92 |
| F | 104 | G | 110 | I | 110 | L | 190 | S | 90 |
| V | 20 | Z | 90 | d | 101 | Ø | 9x16 | | |

WIRING DIAGRAM

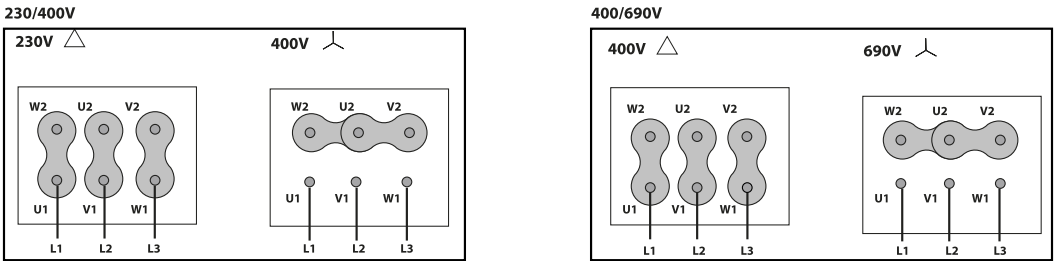

ACCESSORIES



SAFETY SWITCH
INT 25 3P A
REF: INT253PA



STAINLESS STEEL INLET PROTECTION GUARD
FOR CENTRIFUGAL FANS
RAI 13/8-13/6
REF: 300716502



FREQUENCY SPEED CONTROLLER
SFC 230 I 2,5A *
REF: SFC230I003



FREQUENCY SPEED CONTROLLER
SFC 400 III 1,2A *
REF: SFC400III1



ACOUSTIC CABINS FOR CENTRIFUGAL FANS
AB (GENERIC)

SPARE PARTS

| | Code | Model | Qty |
|---|-----------|-----------------------------|-----|
| 4 | 721001013 | MOTOR 0,18kW T2 B5 230/400V | x1 |